



AVAILABLE FINISHES:



BSS



PVD



SSS



Certified to british standard
KM 82991



Suitable for 30 + 60 minute
fire doors



For steel based doorsets MM/IMM

HIN-1433-14SSS

102x76x3mm Ball bearing 5 knuckle hinge
Grade 14 160kg



4 7 7 1 1 4 0 14

Variations - HIN1433-14BSS, HIN1433-14PVD

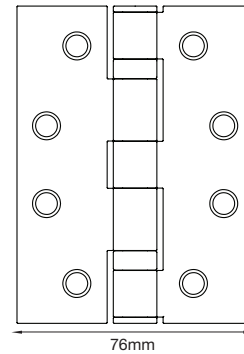
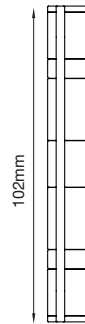

ENDURO®

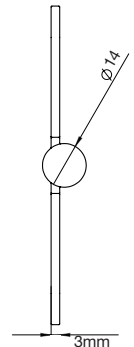

HIN-1433-14PVD-R

102x76x3mm Ball bearing 5 knuckle hinge radius
Grade 14 160kg



4 7 7 1 1 4 0 14

Variations - HIN1433-14SSS-R, HIN1433-14BSS-R

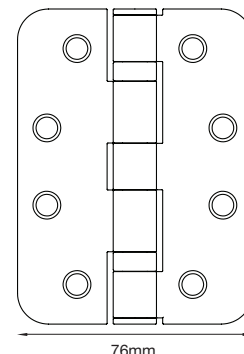
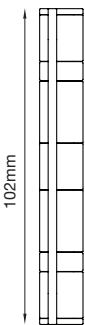

ENDURO®

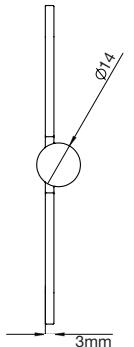

**Certifiere approved
CF339**



**Guaranteed for
25 years**



BS EN 1935



**Supplied in pairs complete
with fixing screws**



CE approved CE1121

Carlisle Brass Ltd
Parkhouse Road
Carlisle
Cumbria
CA3 0JU

Tel: 01228 511 030
Fax: 01228 511 885

AVAILABLE FINISHES:



BSS



PVD



SSS



Certified to british standard
KM 82991



Suitable for 60 minute
fire doors



For steel based doorsets MM/IMM

HIN-1443-14SSS

102x102x3mm Ball bearing 5 knuckle hinge
Grade 14 160kg



4 7 7 1 1 4 0 14

Variations - HIN1443-14BSS, HIN1443-14PVD

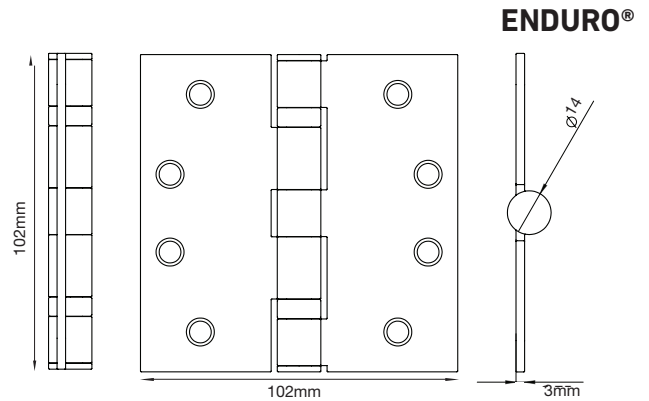

ENDURO®

HIN-1443-14PVD-R

102x102x3mm Ball bearing 5 knuckle hinge radius
Grade 14 160kg



4 7 7 1 1 4 0 14

Variations - HIN1443-14SSS-R, HIN1443-14BSS-R

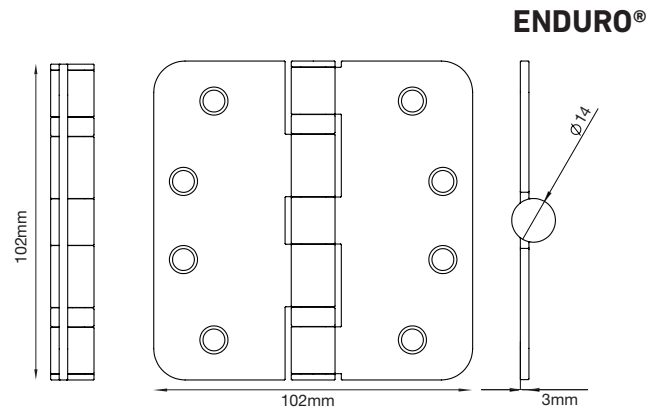

ENDURO®



Certifire approved
CF339



Guaranteed for
25 years



BS EN 1935

BS EN 1935



Supplied in pairs complete
with fixing screws



CE approved CE1121

Carlisle Brass Ltd
Parkhouse Road
Carlisle
Cumbria
CA3 0JU

Tel: 01228 511 030
Fax: 01228 511 885

BS EN 1935:2002 CLASSIFICATION

The European Standard for single-axis hinges used on doors and windows.
Testing and evaluation of the product results in an 8 digit code:

e.g. H3N1207/14 = Classification 4-7-7-1-1-4-0-14

DIGIT 1 - CATEGORY OF USE (Grades 1-4)

Grade 1: Light Duty
Grade 2: Medium Duty
Grade 3: Heavy Duty
Grade 4: Severe Duty

DIGIT 2 - DURABILITY (Grades 3, 4 + 7)

Grade 3: 10,000 Test cycles for light duty hinges on windows only.
Grade 4: 25,000 Test cycles for light duty hinges on windows and doors.
Grade 7: 200,000 Test cycles for medium, heavy and severe duty hinges on doors only.

DIGIT 3 - TEST DOOR MASS (Grades 0-7)

Grade 0: 10 KG Test Door Mass	Grade 4: 80 KG Test Door Mass
Grade 1: 20 KG Test Door Mass	Grade 5: 100 KG Test Door Mass
Grade 2: 40 KG Test Door Mass	Grade 6: 120 KG Test Door Mass
Grade 3: 60 KG Test Door Mass	Grade 7: 160 KG Test Door Mass

DIGIT 4 - SUITABILITY FOR USE ON FIRE/SMOKE DOORS (Grades 0-1)

Grade 0: Not suitable for use on smoke/fire door assemblies.
Grade 1: Suitable for use on smoke/fire door assemblies. Subject to satisfactory assessment under BS EN 1634.

DIGIT 5 - SAFETY (Grade 1)

Grade 1: Single-axis hinges are required to satisfy the essential requirement of safety in use.

DIGIT 6 - CORROSION RESISTANCE (Grades 0-4)

Grade 0: No defined corrosion resistance
Grade 1: Mild resistance
Grade 2: Moderate resistance
Grade 3: High resistance
Grade 4: Very high resistance

DIGIT 7 - SECURITY (Grades 0-1)

Grade 0: No security
Grade 1: Suitable for application requiring a degree of security.

DIGIT 8 - HINGE GRADE (Grades 1-14)

Hinge Grade	Usage	Test Cycles	Door Mass
Grade 1:	Window	10,000	10 KG
Grade 2:	Window	10,000 20 KG	
Grade 3:	Window/Door	25,000	20 KG
Grade 4:	Door	200,000	20 KG
Grade 5:	Window	10,000	40 KG
Grade 6:	Window/Door	25,000	40 KG
Grade 7:	Door	200,000	40 KG
Grade 8:	Window	10,000	60 KG
Grade 9:	Window/Door	25,000	60 KG
Grade 10:	Door	200,000	60 KG
Grade 11:	Door	200,000	80 KG
Grade 12:	Door	200,000	100 KG
Grade 13:	Door	200,000	120 KG
Grade 14:	Door	200,000	160 KG

For full details of test criteria please visit www.carlislebrass.com